

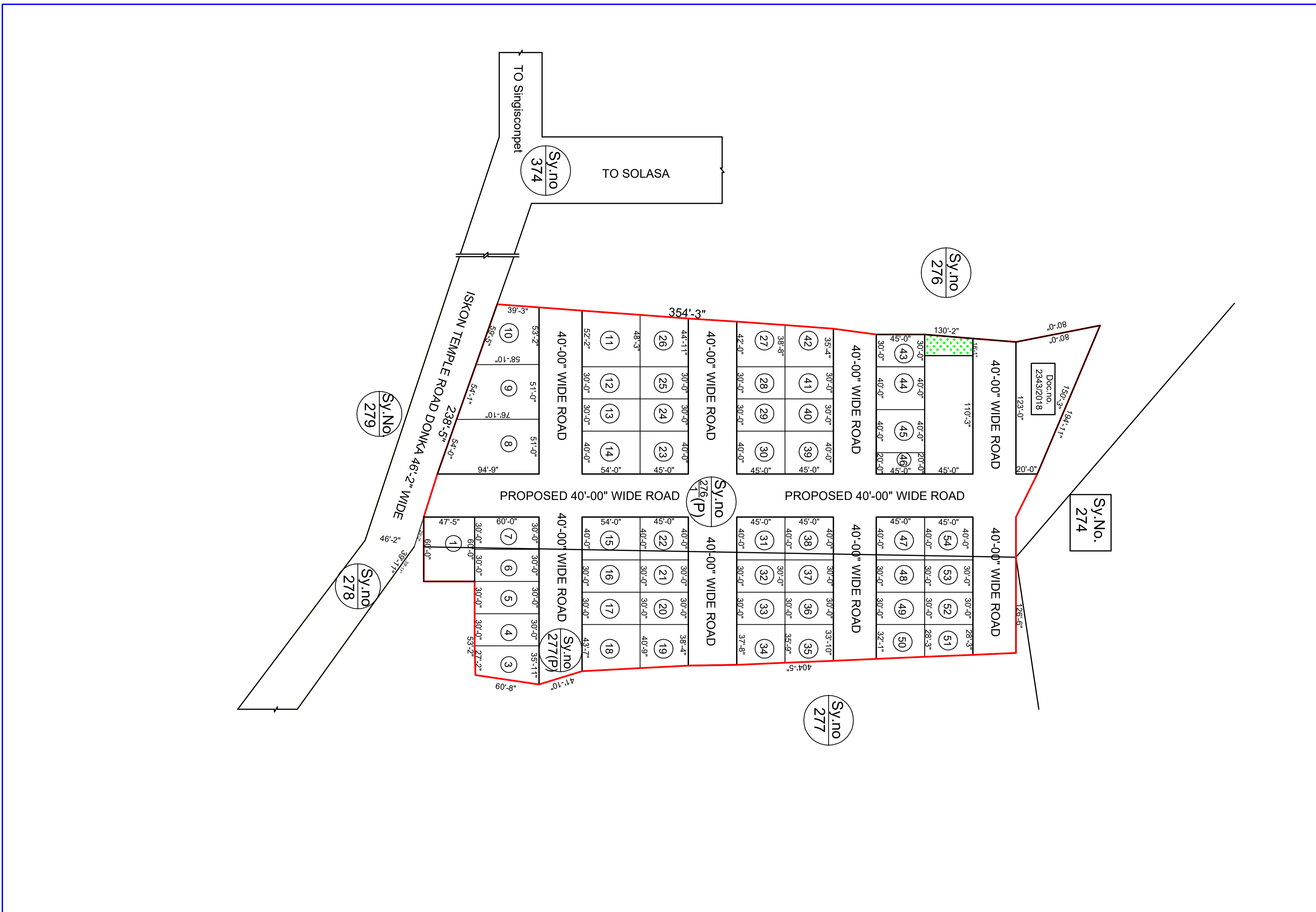

IPLP No : IPLP2020/AMRDA/KOND/000177  
 GRAM PANCHAYAT : KONDAVEEDU  
 DEVELOPMENT AUTHORITY : AMRDA  
 DISTRICT : GUNTUR



**IN PRINCIPLE LAYOUT PATTERN IN  
 Sy.No. 276/1(P) & 277(P) OF KONDAVEEDU  
 VILLAGE, EDLAPADU MANDAL, GUNTUR DIST.**

KONDAVEEDU  
 GOOGLE MAP EXTRACT  
 Site:



**REFERENCE**

- LAYOUT BOUNDARY
- EXISTING ROADS
- OPEN SPACE AREA

NO. OF PLOTS : 54 Nos  
 UNSOLD PLOTTED AREA : Ac.0.13cents or 535.77sqm  
 14% OPEN SPACE OF UNSOLD PLOTS : Ac.0.02cents or 74.82sqm

Note : Plot No.2 is not included in the layout as there is no approach road

Area Statement		Area (In Sq.m)	Area (In Acres)	Percentage(%)
Total Layout Area :-		Ac 3.97 Cents or 16078.40 Sqm		
Total Roads Area :-		Ac 1.55 Cents or 6291.15 Sq.m		
S.No	Area (In Sqm)	Area (In Sq.m)	Area (In Acres)	Percentage(%)
1	Plotted Area	9712.43	2.40	60.41
2	Existing Area of internal Roads	6291.15	1.55	39.13
3	Road Widening Area in 9.0M Road	-	-	-
4	Area affected under ZDP/RDP	-	-	-
5	Area affected under Service Road	-	-	-
6	Open Space Extent	74.82	0.02	0.46
Total		16078.40	3.97	100

AMARAVATI METRO POLITAN REGION DEVELOPMENT AUTHORITY

SCALE : 1" - 66'00"

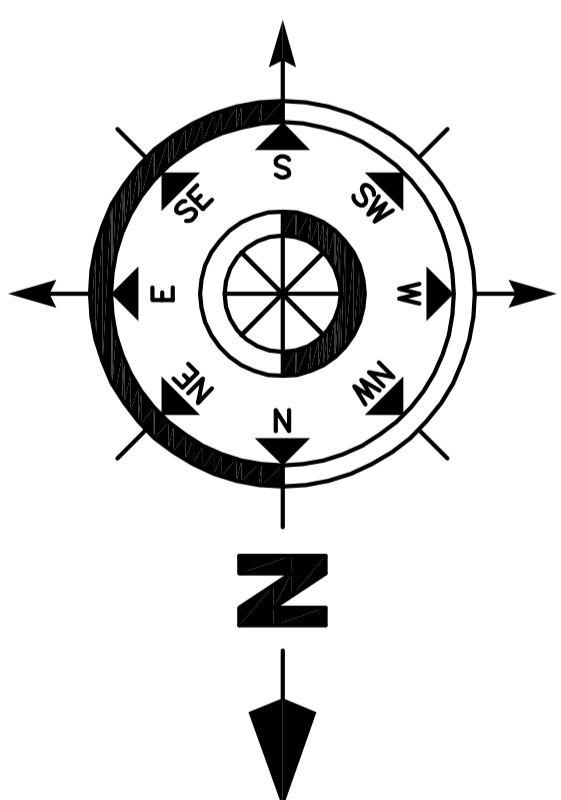

**NOTE :-**

- In principle layout pattern is approved as per Rule 8 of G.O.Ms.No.10 MA&UD Dept, Dt:10-01-2020.
- Only those unapproved layouts and sub-division of plots with registered sale deed/title deed as a plot prior to 31.08.2019 shall be considered for Regularisation.
- This "In principle approved layout" only to the extent of Road patterns, width of roads and Open spaces. In case any discrepancies in between layout and title deeds, the measurements and areas shown in the title deed shall prevail.
- Regularisation of unapproved layout framework will not automatically Regularise the individual plot in the layout. The individual plot owner/promoter (in the case of unsold plots) shall apply for Regularisation of his/her plot/plots separately under LRS 2020.
- After approval of IN Principle layout pattern, if the sanctioning authority noticed that the layout owner/Developer having unsold plots, 14% of unsold area (as on 31.08.2019) towards Open space in the layout shall be handover to local body through registered gift deed at appropriate location as suggested by the ULB/DA. In such case, revised In Principle layout pattern plan shall be obtained from Competent Authority.
- Approval of In Principle Layout pattern doesn't mean any unauthorised building in the plot is regularised
- 14% open space earmarked in the In principle layout pattern shall be treated as deemed to be handed over to concerned local body

8. The plots are shown in the layout as per the information available, necessary correction may be made in future by the competent authority if applied with Documentary evidence.
9. The alignment of water bodies shall not be disturbed and shall maintain as per the revenue and Irrigation records. If any plot is affected in water course/buffer zone the Regularisation shall become invalid.
10. The sanctioning authority shall ensure that the layout developer/owner shall hand over openspace to the Local Body through registered gift deed before considering regularisation of unsold plots . For Plots sold out before cutoff date, can be considered for regularisation even before handing over of open space earmarked in the plan.

SIGNATURE OF THE COMPETENT AUTHORITY  
METROPOLITAN COMMISSIONER  
AMARAVATI METROPOLITAN REGION DEVELOPMENT AUTHORITY